

Ray-Vin AR-15 Front Weight Installation Instructions

First: Clear the weapon!
Magazine out, bolt open and inspect the chamber for the absence of brass.
Wash hands after handling lead products.

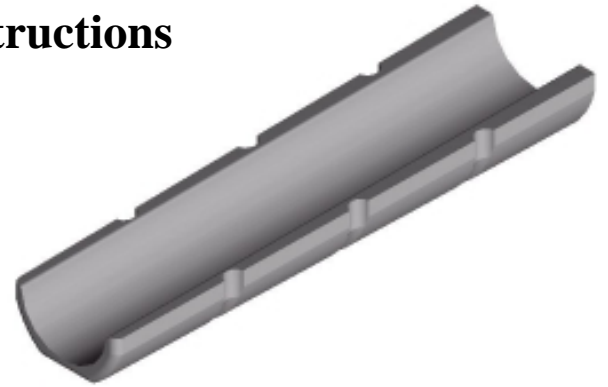

Lead Warning:
Danger! May be fatal or cause serious illness if inhaled or swallowed.
Lead and other elements can be hazardous to your health and the health of others.
Lead work processes may create fumes or dust.
Avoid breathing dust and fumes.
Keep lead dust, dross, and oxide containers closed.
Use only with adequate ventilation and/or appropriate respiratory protection.
Use appropriate personal protective equipment.
Wash face and hands thoroughly after handling.
In case of illness from inhalation or ingestion, get medical attention.

Pull the delta ring back to release the lower handguard. Place the weight against the float tube and determine if you have a 1-3/8" tube or a 1-1/4" tube. The weight will fit flush to the 1-3/8" tube, but there will be a gap against a 1-1/4" tube.

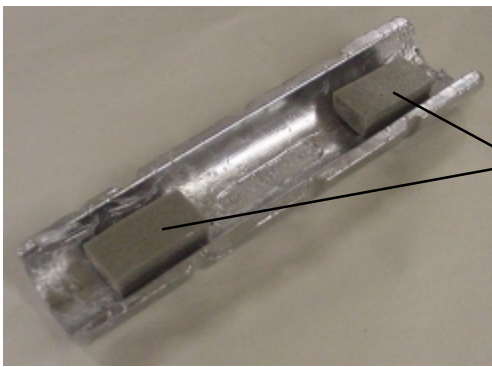
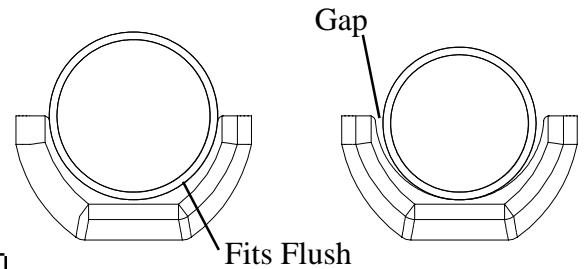

If you have the 1-1/4" float tube, foam weather stripping pads should be applied to the weight to keep it from rattling around.

Place the weight into the lower handguard.



Reinstall the lower handguard. The upper handguard is only removed here for clarity.

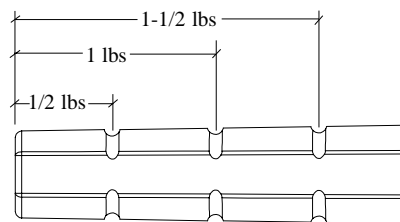

The Front Weight is approximately two pounds. You can customize your balance using this chart as a rough guide.